

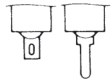





EIGHT SWITCH SERIES

8 Switch Series Selection Table

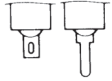
Part No.	Name	Actuator shape	Number of poles	Switching function	Terminal style	Page
8H	Lever · Rocker		1 · 2	ON — ON ON — OFF — ON (ON) — OFF — (ON) ON — (ON)	 S/D P/C	338
8HD	Lever · Rocker (Dust Proof)		1 · 2		 S/D P/C	340
8M	Small Lever Rocker		1 · 2 · 3 · 4		 S/D	342
8V—M	Small Lever · Rocker PC		1 · 2		 P/C	344

●S/D : Show Solder terminal.
 ●P/C : Show PC terminal.

Note: For overseas standards, see page 575.

8 Switch Series Common Specifications

Contact specs.		Silver	Gold plated
Rating	Max.	125VAC 6A 250VAC 3A 30VAC 4A	20VDC 25mA
Initial contact resistance		10mΩ Max. (2~4VDC 1A)	20mΩ Max. (200 μVAC 1.5mA)
Initial dielectric strength		AC1500V 1 Minute	
Initial insulation resistance		1000MΩ Min.	(500VDC)
Electrical life	Alternate type	50,000 cycles	
	Momentary type	25,000 cycles	
Operating temperature range		-30~+85°C	
Storage temperature range		-40~+85°C	

Part Numbering

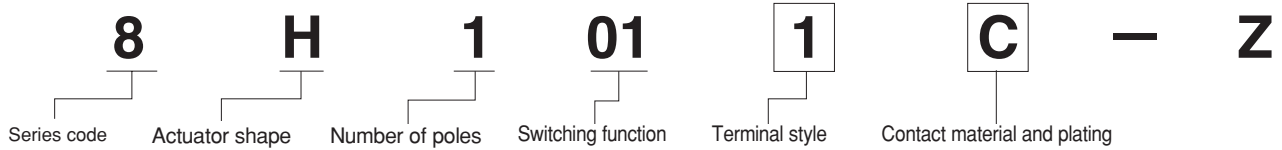

Code	Type
H	Lever•Rocker
HD	Lever•Rocker
M	Small Lever•Rocker
V-M	Small Lever•Rocker

Fig.	Number of poles
1	1 pole
2	2 poles
3	3 poles
4	4 poles

Fig.	Switching function
01	ON - ON
02	ON - OFF - ON
04	(ON)-OFF-(ON)
06	ON - (ON)

Fig.	Terminal style
1	Solder Terminal
2	PC Straight

Code	Contact material	Plating
None	Bs+Ag or Cu+Ag	Ag
C	Bs+Ag or Cu+Ag	Ni+Au

Bs=Brass.
 Cu=Copper.
 Ag=Silver.
 Ni=Nickel.
 Au=Gold

Note : For some products, the part numbers according to the above-stated combinations are not registered yet. Check the Table of Part Numbers for availability.

Terminal Styles

Terminal style	Solder Terminal (Style : 1)	PC Straight (Style : 2)
Dimensions		

PC Hole Layouts

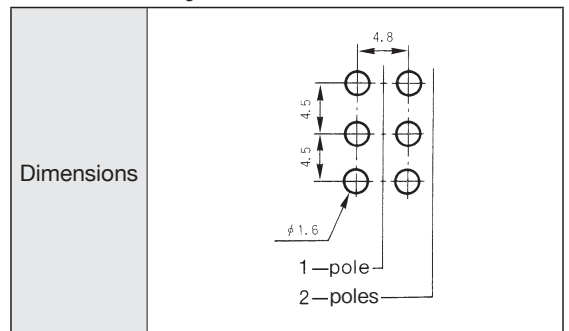

8V-M/PC Hole Layouts

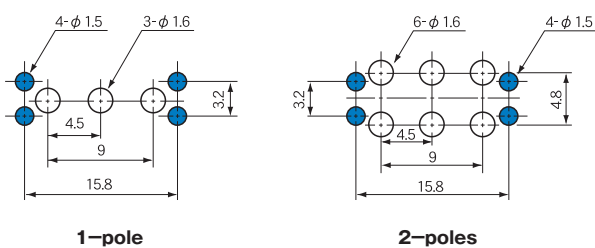

(ON) : Momentary.

8HD

Lever & Rocker Switches

Dust Proof

RoHS Compliant



UL CSA

Features

The **8HD** Lever & Rocker switch is a dustproof version of the **8H** type and is best suited for use in the adverse environment where a lot of dust exists. The lever, rocker, and mounting frame are available in four matted colors. Choose the suitable one for the panel design.

- ① Dustproof structure.
- ② Snap-in mounting on panel.
(The hole layout is same as the **8H** type.)
- ③ The side-by-side mounting will not cause gap between switches.
- ④ Colorful mat-finished levers and rockers that enhance the panel design can be mounted.

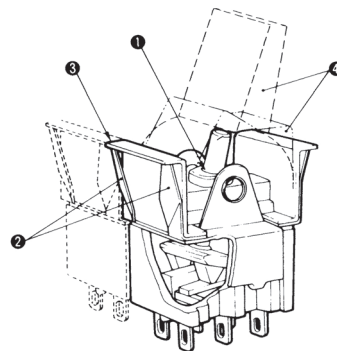

SPDT

Dust Proof

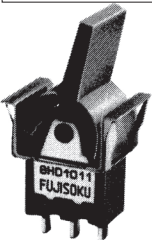

Mount with **Lever**

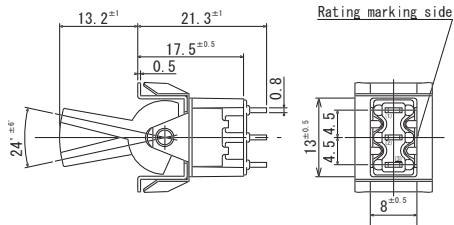
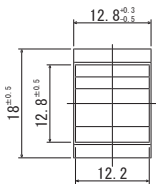

Terminal numbers are not shown on the bottom of the switch.

Switching function	Viewed from rating marking side		
Part No.			
8HD101 ■ - Z	ON	—	ON
8HD104 ■ - Z	(ON)	OFF	(ON)
Connecting terminals	2-3	—	2-1

■ : Look at follows.

DPDT

Dust Proof



Mount with **Rocker**

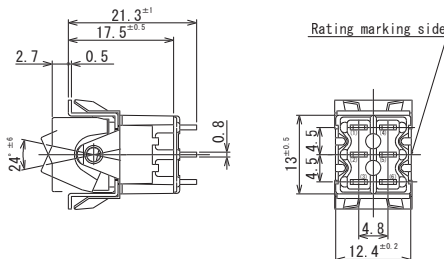
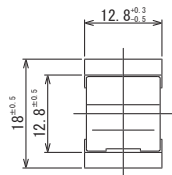

Terminal numbers are not shown on the bottom of the switch.

Switching function	Viewed from rating marking side		
Part No.			
8HD201 ■ - Z	ON	—	ON
8HD202 ■ - Z	ON	OFF	ON
Connecting terminals	2-3 5-6	—	2-1 5-4

■ : Look at follows.

(ON) : Momentary.

■ Lever・Rocker Installation Procedure

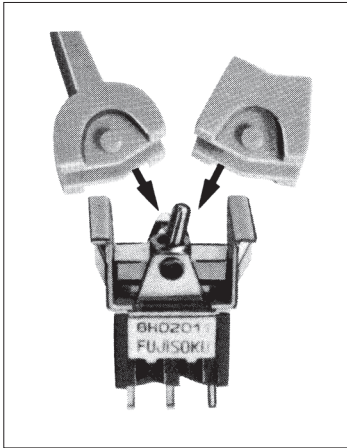

■ Mounting Frame mounting Method

● Install the mounting frame as shown in the photo below.

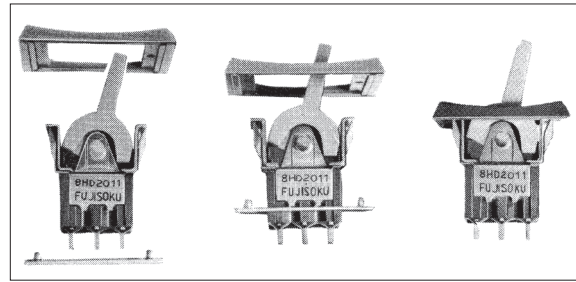

● To mount the switch on the panel, press in the switch from the panel side with uniform pressure on the right and left.

■ Table of Part Numbers

Terminal style	Switching function	1-pole	2-pole
Solder Terminal	ON - ON	☆ 8HD1011-Z	☆ 8HD2011-Z
	ON - OFF - ON	—	☆ 8HD2021-Z
	(ON) - OFF - (ON)	★ 8HD1041-Z	—
PC Straight	ON - ON	—	★ 8HD2012-Z

Some products in the Table of UL and CSA-Approved Products are not registered yet. Before placing the order, check with our Sales Department.

■ Accessories

〈Supplied separately〉

Part Name	Standard Accessories		Optional Accessories
	Lever	Rocker	Mounting Frame
Dimensions			
White	14000050558	140000480594	140000340127 + 140000600181
Red	14000050559	140000480595	140000340128 + 140000600181
Black	14000050560	140000480596	140000340129 + 140000600181
Gray	14000050561	140000480597	140000340130 + 140000600181

○ Specify either one of Lever or Rocker in part number when placing an order.

■ Panel Cut-Out Dimensions

Panel thickness (with Mounting Frame) : 1 to 2.5mm

Panel thickness (with Mounting Frame) : 1 to 3mm

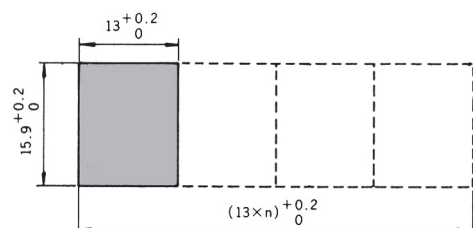
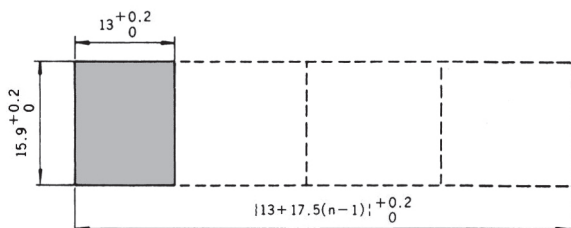

★ : Made to order products. ● For Soldering Specifications and Flux Cleaning, see page 349.

□ : Optional Accessories. (ON) : Momentary. ☆ : Semi-standard products.

UL、CSA認定品一覧表 (Lever・Rocker Type Only)

UL and CSA listed

■エイトスイッチシリーズ/8Switch Series

Poles	Switching function			UL (File No.E43275)				CSA (File No.LR38341)				
				8H	8HD	8M	8V-M	8H	8HD	8M	8V-M	
1-pole	101□	ON	—	ON	○	○	○	○	○	○	○	○
	102□	ON	—	OFF —	ON	○				○		
	104□	(ON)	—	OFF —	(ON)	○	○			○	○	
	106□	ON	—	(ON)		○			○			○
2-poles	201□	ON	—	ON	○	○	○	○	○	○	○	○
	202□	ON	—	OFF —	ON	○	○			○	○	
	204□	(ON)	—	OFF —	(ON)	○				○		
	206□	ON	—	(ON)		○			○			○
3-poles	301□	ON	—	ON			○				○	
4-poles	401□	ON	—	ON			○				○	

- (1) □ shows the terminal type of ① : Solder terminal; ② : PC terminal.
- (2) Some products in the Table of UL and CSA Listed are not registered yet. Before placing the order, check with our Sales Department.
- (3) For the registered products, refer to Table of Part Numbers of respective Series products.
- (4) When the UL and CSA approved products are required, specify "UL /CSA approved Product" when placing the order. The products will be delivered with the UL or CSA marking.

■Handling Precautions(EIGHT switch series)

1. Soldering Specifications

- (1) Soldering Specifications
Device : Soldering iron
① 420°C, Max.; 3 sec., Max.
- (2) Auto Soldering
② 275°C ± 10°C, Max.; 5 seconds, Max.
Note that the above-stated soldering conditions should be applied to the PC terminal type only.

3. Mounting

- Do not bend the terminals before mounting the switch on the PC board.
- After mounting the switch, do not place the device in such a way that the device weight will be applied on the knob of the switch.
- To fix the PC terminal type, solder it on the PC board after fixing the switch body on the panel with the screw.

2. Flux Cleaning

- (1) For the solvent, use the fluorine- or alcohol-based solvent.
Solvent: Fluorine or Alcohol type
- (2) Since the 8 Switch Series switches are not waterproof-structured, if the PC board is to be cleaned, clean the soldering surface of substrate with a brush so that the switch is not exposed to the cleaning solution.