

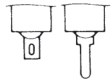





EIGHT SWITCH SERIES

8 Switch Series Selection Table

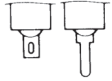
Part No.	Name	Actuator shape	Number of poles	Switching function	Terminal style	Page
8H	Lever · Rocker		1 · 2	ON — ON ON — OFF — ON (ON) — OFF — (ON) ON — (ON)	 S/D P/C	338
8HD	Lever · Rocker (Dust Proof)		1 · 2		 S/D P/C	340
8M	Small Lever Rocker		1 · 2 · 3 · 4		 S/D	342
8V—M	Small Lever · Rocker PC		1 · 2		 P/C	344

●S/D : Show Solder terminal.
 ●P/C : Show PC terminal.

Note: For overseas standards, see page 575.

8 Switch Series Common Specifications

Contact specs.		Silver	Gold plated
Rating	Max.	125VAC 6A 250VAC 3A 30VAC 4A	20VDC 25mA
Initial contact resistance		10mΩ Max. (2~4VDC 1A)	20mΩ Max. (200 μVAC 1.5mA)
Initial dielectric strength		AC1500V 1 Minute	
Initial insulation resistance		1000MΩ Min.	(500VDC)
Electrical life	Alternate type	50,000 cycles	
	Momentary type	25,000 cycles	
Operating temperature range		-30~+85°C	
Storage temperature range		-40~+85°C	

Part Numbering

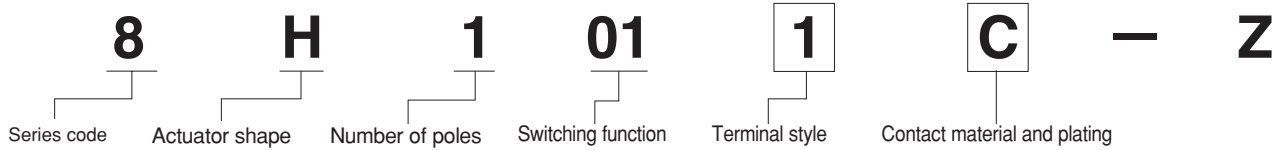

Code	Type
H	Lever•Rocker
HD	Lever•Rocker
M	Small Lever•Rocker
V-M	Small Lever•Rocker

Fig.	Number of poles
1	1 pole
2	2 poles
3	3 poles
4	4 poles

Fig.	Switching function
01	ON - ON
02	ON - OFF - ON
04	(ON)-OFF-(ON)
06	ON - (ON)

Fig.	Terminal style
1	Solder Terminal
2	PC Straight

Code	Contact material	Plating
None	Bs+Ag or Cu+Ag	Ag
C	Bs+Ag or Cu+Ag	Ni+Au

Bs=Brass.
 Cu=Copper.
 Ag=Silver.
 Ni=Nickel.
 Au=Gold

Note : For some products, the part numbers according to the above-stated combinations are not registered yet. Check the Table of Part Numbers for availability.

Terminal Styles

Terminal style	Solder Terminal (Style : 1)	PC Straight (Style : 2)
Dimensions		

PC Hole Layouts

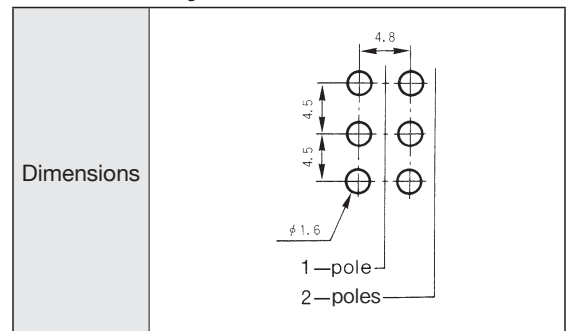

8V-M/PC Hole Layouts

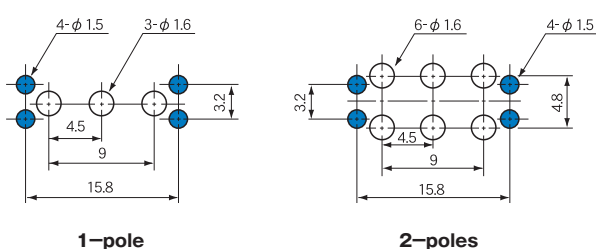

(ON) : Momentary.

8H

Lever & Rocker Switches



UL CSA

RoHS Compliant

Features

The 8H Lever & Rocker Switches feature the snap-in mount type on the panel, which enables side-by-side mounting. For the actuator, either of the lever or the rocker can be chosen according to applications and four colors are available for the actuator and the mounting frame, respectively. Choose the suitable one for the panel design.

SPDT

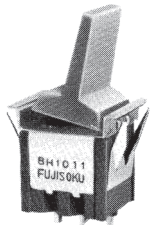

Mount with lever

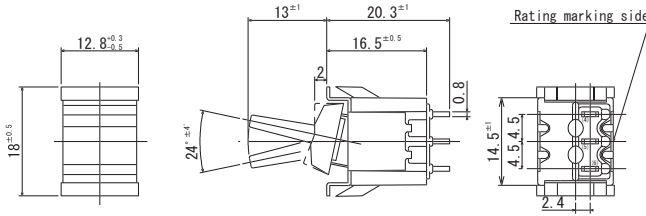

Terminal numbers are not shown on the bottom of the switch.

Switching function	Viewed from rating marking side		
Part No.			
8H101--Z	ON	—	ON
8H102--Z	ON	OFF	ON
8H104--Z	(ON)	OFF	(ON)
8H106--Z	ON	—	(ON)
Connecting terminals	5-6	—	5-4

■ : Look at follows.

DPDT

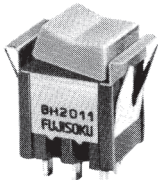

Mount with rocker

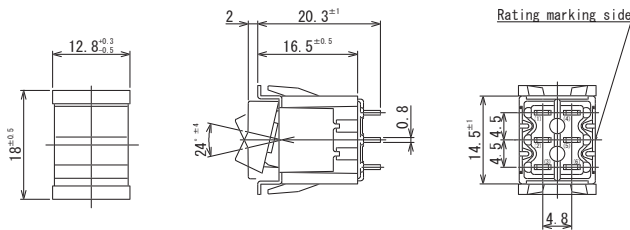

Terminal numbers are not shown on the bottom of the switch.

Switching function	Viewed from rating marking side		
Part No.			
8H201--Z	ON	—	ON
8H202--Z	ON	OFF	ON
8H204--Z	(ON)	OFF	(ON)
8H206--Z	ON	—	(ON)
Connecting terminals	2-3 5-6	—	2-1 5-4

■ : Look at follows.

Table of Part Numbers

Terminal style	Switching function	1 pole	2 poles
Solder Terminal	ON — ON	☉ 8H1011-Z ☆ 8H1011C-Z	☉ 8H2011-Z
	ON — OFF — ON	☆ 8H1021-Z ▲ 8H1021C-Z	★ 8H2021-Z
	(ON) — OFF — (ON)	☉ 8H1041-Z	★ 8H2041-Z
	—	★ 8H1051-Z	—
	ON — (ON)	☉ 8H1061-Z	—
PC Straight	ON — ON	★ 8H1012-Z	★ 8H2012-Z
	ON — (ON)	—	★ 8H2062-Z

Some products in the Table of UL and CSA Listed are not registered yet. Before placing the order, check with our Sales Department.

(ON) : Momentary.

★ : Made to order products.

● For Soldering Specifications and Flux Cleaning, see page 349.

☆ : Semi-standard products.

▲ : Inquiry products.

Panel Cut-Out Dimensions

Panel thickness (with **Mounting Frame**) : 1 to 2.5mm

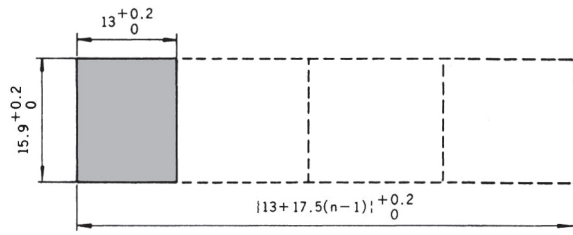

Panel thickness (with **Mounting Frame**) : 1 to 3mm

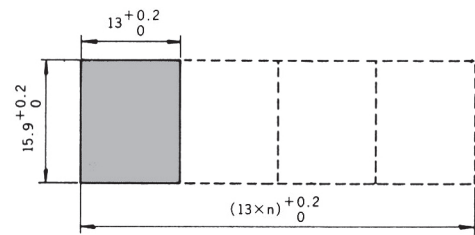

Lever · Rocker Installation Procedure

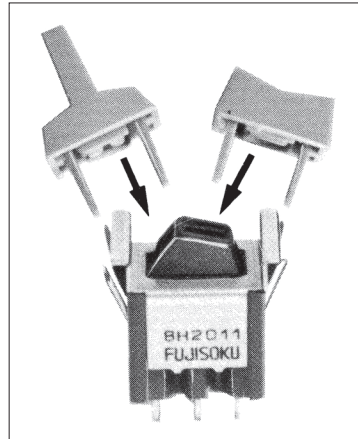

Mounting Frame mounting Method

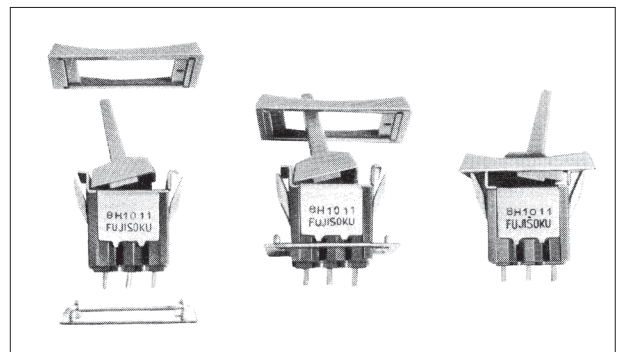

Accessories

⟨Supplied separately⟩

Part Name	Standard Accessories		Optional Accessories
	Lever	Rocker	Mounting Frame
Gloss finish			
Dimensions			
White	14000050693	140000480332	140000340086 + 140000600181
Red	—	140000480334	140000340087 + 140000600181
Black	14000050695	140000480333	140000340088 + 140000600181
Gray	—	—	140000340089 + 140000600181

● Specify either one of Lever or Rocker in part number when placing an order.

PC Hole Layouts

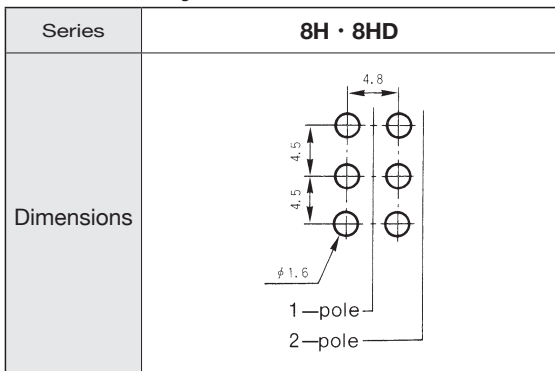

Terminal Styles

Series	8H · 8HD	
Terminal style	Solder Terminal (Style : 1)	PC Straight (Style : 2)
Dimensions		

Optional Accessories. (ON) : Momentary.

UL、CSA認定品一覧表 (Lever・Rocker Type Only)

UL and CSA listed

■エイトスイッチシリーズ/8Switch Series

Poles	Switching function			UL (File No.E43275)				CSA (File No.LR38341)				
				8H	8HD	8M	8V-M	8H	8HD	8M	8V-M	
1-pole	101□	ON	—	ON	○	○	○	○	○	○	○	○
	102□	ON	—	OFF —	ON	○				○		
	104□	(ON)	—	OFF —	(ON)	○	○			○	○	
	106□	ON	—	(ON)		○			○	○		○
2-poles	201□	ON	—	ON	○	○	○	○	○	○	○	○
	202□	ON	—	OFF —	ON	○	○			○	○	
	204□	(ON)	—	OFF —	(ON)	○				○		
	206□	ON	—	(ON)		○			○	○		○
3-poles	301□	ON	—	ON			○				○	
4-poles	401□	ON	—	ON			○				○	

- (1) □ shows the terminal type of ① : Solder terminal; ② : PC terminal.
- (2) Some products in the Table of UL and CSA Listed are not registered yet. Before placing the order, check with our Sales Department.
- (3) For the registered products, refer to Table of Part Numbers of respective Series products.
- (4) When the UL and CSA approved products are required, specify "UL /CSA approved Product" when placing the order. The products will be delivered with the UL or CSA marking.

■Handling Precautions(EIGHT switch series)

1. Soldering Specifications

- (1) Soldering Specifications
Device : Soldering iron
① 420°C, Max.; 3 sec., Max.
- (2) Auto Soldering
② 275°C ± 10°C, Max.; 5 seconds, Max.
Note that the above-stated soldering conditions should be applied to the PC terminal type only.

3. Mounting

- Do not bend the terminals before mounting the switch on the PC board.
- After mounting the switch, do not place the device in such a way that the device weight will be applied on the knob of the switch.
- To fix the PC terminal type, solder it on the PC board after fixing the switch body on the panel with the screw.

2. Flux Cleaning

- (1) For the solvent, use the fluorine- or alcohol-based solvent.
Solvent: Fluorine or Alcohol type
- (2) Since the 8 Switch Series switches are not waterproof-structured, if the PC board is to be cleaned, clean the soldering surface of substrate with a brush so that the switch is not exposed to the cleaning solution.