

**JUMO GmbH & Co. KG**

Delivery address: Mackenrodtstraße 14,  
36039 Fulda, Germany  
Postal address: 36035 Fulda, Germany  
Phone: +49 661 6003-0  
Fax: +49 661 6003-607  
E-mail: mail@jumo.net  
Internet: www.jumo.net

**JUMO Instrument Co. Ltd.**

JUMO House  
Temple Bank, Riverway  
Harlow - Essex CM20 2DY, UK  
Phone: +44 1279 63 55 33  
Fax: +44 1279 63 52 62  
E-mail: sales@jumo.co.uk  
Internet: www.jumo.co.uk

**JUMO Process Control, Inc.**

8 Technology Boulevard  
Canastota, NY 13032, USA  
Phone: 315-697-JUMO  
1-800-554-JUMO  
Fax: 315-697-5867  
E-mail: info@jumo.us  
Internet: www.jumo.us

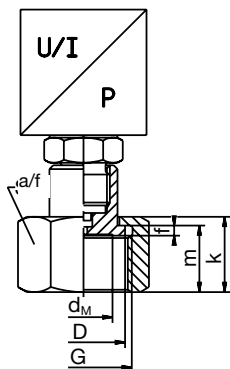

# Pressure separator with ISS connection or SMS connection or RJT connection and slotted ring nut Type 409778

**Diaphragm pressure separator with ISS connection****Technical data**

Process connection	Nominal pressure bar	Recommended min. pressure range bar	Temperature coefficient mbar/10°C	Weight (without meas. device) kg	Dimensions [mm]						
					a/f	d <sub>M</sub>	D	thread G	f	m	k
DN1"	PN40	above 6	+30	0.35	47	24	33	1½ x 1/8"	4	26.5	30
DN1½"		above 0.4	+12	0.59	62	34	47	2 x 1/8"			
DN2"		above 0.1	+3	1.00	77	45	60	2½ x 1/8"			

**JUMO GmbH & Co. KG**

Delivery address: Mackenrodtstraße 14,  
36039 Fulda, Germany  
Postal address: 36035 Fulda, Germany  
Phone: +49 661 6003-0  
Fax: +49 661 6003-607  
E-mail: mail@jumo.net  
Internet: www.jumo.net

**JUMO Instrument Co. Ltd.**

JUMO House  
Temple Bank, Riverway  
Harlow - Essex CM20 2DY, UK  
Phone: +44 1279 63 55 33  
Fax: +44 1279 63 52 62  
E-mail: sales@jumo.co.uk  
Internet: www.jumo.co.uk

**JUMO Process Control, Inc.**

8 Technology Boulevard  
Canastota, NY 13032, USA  
Phone: 315-697-JUMO  
1-800-554-JUMO  
Fax: 315-697-5867  
E-mail: info@jumo.us  
Internet: www.jumo.us

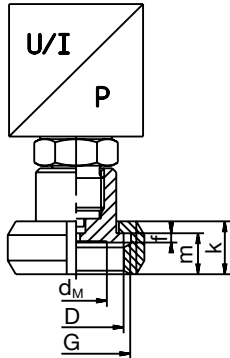
**Diaphragm pressure separator with SMS connection****Technical data**

Process connection	Nominal pressure bar	Recommended min. pressure range bar	Temperature coefficient mbar/10°C	Weight (without meas. device) kg	Dimensions [mm]					
					d <sub>M</sub>	D	thread G	f	m	k
DN1"	PN40	above 6	+30	0.22	24	35.5	Rd40 x 1/6"	3.5	15.5	20
DN1½"		above 0.4	+12	0.60	34	55	Rd60 x 1/6"	4	21	25
DN2"		above 0.1	+3	1.00	46	65	Rd70 x 1/6"			26

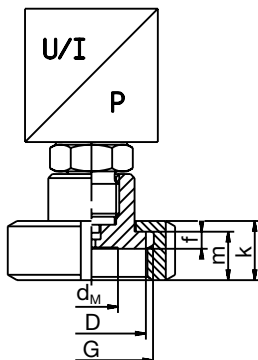
**Diaphragm pressure separator with RJT connection****Technical data**

Process connection	Nominal pressure bar	Recommended min. pressure range bar	Temperature coefficient mbar/10°C	Weight (without meas. device) kg	Dimensions [mm]					
					d <sub>M</sub>	D	thread G	f	m	k
DN1"	PN40	above 6	+30	0.40	20	41	1 <sup>13</sup> / <sub>16</sub> x 1/8"	6.4	18	22
DN1½"		above 0.4	+12	0.75	28	54	2 <sup>5</sup> / <sub>16</sub> x 1/8"			22
DN2"		above 0.1	+6	1.00	38	67	2 <sup>7</sup> / <sub>8</sub> x 1/6"		18	22

**JUMO GmbH & Co. KG**

Delivery address: Mackenrodtstraße 14,  
36039 Fulda, Germany  
Postal address: 36035 Fulda, Germany  
Phone: +49 661 6003-0  
Fax: +49 661 6003-607  
E-mail: mail@jumo.net  
Internet: www.jumo.net

**JUMO Instrument Co. Ltd.**

JUMO House  
Temple Bank, Riverway  
Harlow - Essex CM20 2DY, UK  
Phone: +44 1279 63 55 33  
Fax: +44 1279 63 52 62  
E-mail: sales@jumo.co.uk  
Internet: www.jumo.co.uk

**JUMO Process Control, Inc.**

8 Technology Boulevard  
Canastota, NY 13032, USA  
Phone: 315-697-JUMO  
1-800-554-JUMO  
Fax: 315-697-5867  
E-mail: info@jumo.us  
Internet: www.jumo.us

**Order details**

	<b>(1) Basic type</b>
409778	pressure separator with ISS connection or with SMS connection or with RJT connection and slotted ring nut
	<b>(2) Basic type extension</b>
00	none
	<b>(3) Process connection</b>
587	ISS DN1"
588	ISS DN1 <sup>1</sup> / <sub>2</sub> "
589	ISS DN2"
584	SMS DN1"
585	SMS DN1 <sup>1</sup> / <sub>2</sub> "
586	SMS DN2"
577	RJT DN1"
578	RJT DN1 <sup>1</sup> / <sub>2</sub> "
579	RJT DN2"
	<b>(4) Nominal pressure in bar</b>
040	PN40
	<b>(5) Material</b>
20	st. steel
99	special material <sup>1</sup>
	<b>(6) Filling liquid</b>
1	silicone oil
2	halogenized oil
3	vegetable oil
	<b>(7) Capillary</b>
0000	no capillary
0001	with cooling device
1000	1.0 m capillary
1500	1.5 m capillary
2000	2.0 m capillary
3000	3.0 m capillary
5000	5.0 m capillary

	(1)	(2)	(3)	(4)	(5)	(6)	(7)
<b>Order code</b>	<input type="text"/>	/	<input type="text"/>	-	<input type="text"/>	-	<input type="text"/>
<b>Order example</b>	409778	/	00	-	588	-	040 - 20 - 3 - 1500

<sup>1</sup> please specify in plain text when ordering