

# HTR-W3

## ROTARY ENCODER LIGHT DUTY



- Light Duty
- Shaft Diameter 6 mm
- Push Pull, Line Driver
- DC 5~26V

### DIMENSION

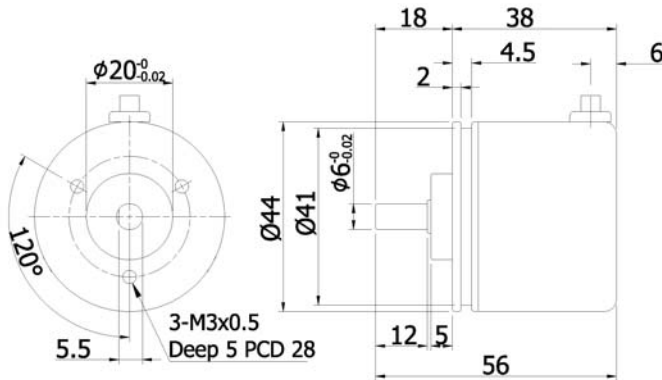

### ORDERING INFORMATION

|          |  |     |                                 |
|----------|--|-----|---------------------------------|
| HTR-W3 - |  | A - |                                 |
|          | Pulse per Revolution<br>解析   |     | Electronics<br>電路特性             |
|          | 5, 10, 50, 100, 200,<br>300, 360, 400, 500,<br>600, 900, 1000,<br>1024, 1200, 1500,<br>1800, 2000, 2048,<br>2500 |     | P: Push Pull<br>*H: Line Driver |

### ELECTRICAL SPEC.

|   |  |
|---|--|
| Detection System                              | Incremental 增量型  |
| Output Wave 輸出波形                              | Square Wave 方波   |
| Standard Number of Pulse Per Revolution<br>解析 | 5, 10, 50, 100, 200, 300, 360, 400, 500, 600, 900, 1000, 1024, 1200, 1500, 1800,<br>2000, 2048, 2500 |
| Output Phase 輸出相                              | ABZ phase  |
| Electronics 電路特性                              | Push Pull 推挽式, Line Driver 差動式   |
| Power Supply 供應電源                             | DC 5~26V   |
| Current Consumption 消耗電流                      | ≤ 60 mA  |
| Output Capacity 輸出容量                          | Sync. Current: 20 mA, Residual Voltage: 0.5V or less   |
| Max. Response 最大響應頻率                          | Max. 100K Hz   |
| Phase Different 相位差                           | A, B phase different 90°±45° (T/4±T/8), Z phase T±T/2  |
| Wave Form Rise / Fall 波形上下時間                  | 2 μs or less   |
| Polarity 極性保護                                 | Against Reverse Protection   |

### MECHANICAL SPEC.

|                                |   |
|--------------------------------|---|
| Shaft Diameter 軸徑              | 6 mm  |
| Shaft Loading 軸荷重              | (5 ~ 1024 PPR) Axial 軸向: 1 Kg, Radial 徑向: 2 Kg<br>(over 1024 PPR) Axial 軸向: 0.5 Kg, Radial 徑向: 1 Kg |
| Starting Torque (at 25°C) 起動轉矩 | 30 gf-cm or less  |
| Max. Speed 最大機械容許速度            | 6,000 rpm   |
| Vibration 震動                   | Max. 10g (10 ~55 Hz / 1.5 mm X.Y.X. 2Hr)  |
| Shock 衝擊                       | 20g per 11 ms   |
| Cable 電線                       | Ø4.5, 1000 mm long  |
| Weight 重量                      | ≤ 200g  |

### ENVIRONMENTAL SPEC.

|                                    |  |
|------------------------------------|--|
| Operating Temp. / Humidity 操作溫度/濕度 | 0°C ~ 60°C, RH 35% ~ 90% (No Condensation) |
| Storage Temp. 儲存溫度                 | -20°C ~ 70°C                               |
| Protection 保護等級                    | IP50: Dust Proof                           |