

Fluid control valve(2/2way)

2S Series (Direct-acting and normally closed)

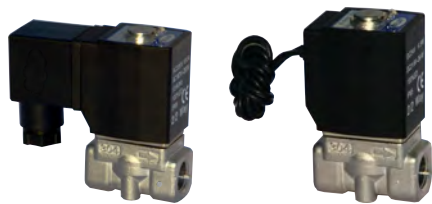

Symbol



Product feature

1. Direct acting and normally closed type 2/2 way solenoid valve. Its high sensibility allows it to change direction quickly;
2. It has wide pressure range, including extra high pressure (X), high pressure (H), standard, large volume(L) and extra large volume (T) to choose from;
3. It is compact, small size and light weight. It is easy to install and dismantle.
4. The valve body is made of SUS304. Its coil has a Heat resistance classification of Class B. The standard seal material is FPM-F. Please contact us if other material are required.
5. The protection class of the coil is IP65 and there is a choice for grommet or terminal electrical entry.

Inner structure

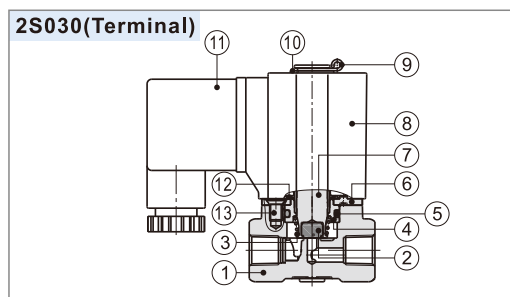

| No. | Item | No. | Item |
|-----|---------------|-----|---------------|
| 1 | Body | 8 | Coil assembly |
| 2 | Airtight ring | 9 | E Clip |
| 3 | Spring | 10 | Gasket |
| 4 | Fixed cap | 11 | Connector |
| 5 | O-ring | 12 | Washer |
| 6 | Fixed plate | 13 | Screw |
| 7 | Movable core | | |

Specification

| Model\Item | Port size [Note1] | Orifice size (Φmm) | Cv | Valid area or section (mm ²) | Weight [Note2](g) | Max.operating pressure differentia | | Proof pressure | |
|------------|----------------------|-----------------------|------|---|----------------------|------------------------------------|-----|----------------|-----|
| | | | | | | MPa | psi | MPa | psi |
| 2SX030 | -06 | 1/8" | 1.5 | 0.10 | 1.8 | 3.0 | 450 | 5.0 | 750 |
| | -08 | 1/4" | | | | | | | |
| 2SH030 | -06 | 1/8" | 2.0 | 0.18 | 3.0 | 2.0 | 300 | 5.0 | 750 |
| | -08 | 1/4" | | | | | | | |
| 2S030 | -06 | 1/8" | 3.0 | 0.33 | 6.0 | 1.0 | 150 | 5.0 | 750 |
| | -08 | 1/4" | | | | | | | |
| 2SL030 | -06 | 1/8" | 4.0 | 0.55 | 10.0 | 0.5 | 75 | 5.0 | 750 |
| | -08 | 1/4" | | | | | | | |
| 2ST030 | -06 | 1/8" | 6.0 | 1.10 | 12.0 | 0.1 | 15 | 5.0 | 750 |
| | -08 | 1/4" | | | | | | | |
| 2SX050 | -10 | 3/8" | 3.0 | 0.34 | 6.1 | 3.0 | 450 | 5.0 | 750 |
| | -15 | 1/2" | | | | | | | |
| 2SH050 | -10 | 3/8" | 4.0 | 0.55 | 10.0 | 2.0 | 300 | 5.0 | 750 |
| | -15 | 1/2" | | | | | | | |
| 2S050 | -10 | 3/8" | 5.0 | 0.83 | 15.0 | 1.0 | 150 | 5.0 | 750 |
| | -15 | 1/2" | | | | | | | |
| 2SL050 | -10 | 3/8" | 7.0 | 1.40 | 25.0 | 0.5 | 75 | 5.0 | 750 |
| | -15 | 1/2" | | | | | | | |
| 2ST050 | -10 | 3/8" | 10.0 | 2.20 | 40.0 | 0.1 | 15 | 5.0 | 750 |
| | -15 | 1/2" | | | | | | | |

[Note1] PT thread, G thread and NPT thread are available.

[Note2] The weight in the table is the terminal valve's weight, 2S030 series grommet valve's weight is 10g less than terminal's. 2S050series grommet valve's weight is 20g less than terminal's.

Specification of coil

| Valve type | Coil type | Power type | Frequency (Hz) | Voltage range | Electrical entry | Power Consumption (VA/W) | Insulation | Temp. rise(°C) |
|------------|------------------|------------|----------------|---------------|------------------|--------------------------|------------|----------------|
| 2S□030 | CDA116 CLA116 | AC | 50 | ±15% | Terminal (CDA) | 10.0VA | Class B | 35 |
| | | | 60 | | | 8.0VA | | 30 |
| 2S□050 | CDA170 CLA170 | AC | 50 | ±15% | Grommet (CLA) | 25.0VA | | 30 |
| | | | 60 | | | 22.0VA | | 60 |
| | | DC | - | ±10% | 12.0W | 55 | | |
| | | | | | | | 40 | |

Valve's specification

| Acting | | Direct acting | | | | |
|--------------------------------------|--|-----------------|-------|-------------|-------------|---------|
| Initial state | | Normally closed | | | | |
| Adaptable fluid | | Air, Water, Oil | | | | |
| Viscosity limit | | Under 20CST | | | | |
| Ambient and fluid temperature (°C) | | | Water | Air | Oil | Ambient |
| | | Max. | 80 | 90 | 80 | 70 |
| | | Min. | 1 | -20 [Note1] | -10 [Note2] | -20 |

[Note1] Dew point: -20(°C) or less ;

[Note2] 50CST or less.

Ordering code

Ordering code of valves

2S L 030 08 A □ □



| ①Model | ②Pressure condition | ③Size series | ④Port size | ⑤Voltage | ⑥Electrical entry | ⑦Thread type |
|---|---|--|--|--|-------------------------------------|-----------------------------|
| 2S: 2/2 way direct-acting and normally closed | X: Extra high pressure H: High pressure Blank: Standard L: Large volume T: Extra large volume | 030: 030 Series 050: 050 Series | 06: 1/8" 08: 1/4" 10: 3/8" 15: 1/2" | A: AC220V B: DC24V C: AC110V E: AC24V F: DC12V | Blank: Terminal I: Grommet[Note] | Blank: PT G: G T: NPT |

Ordering code of accessories

F-2S030 LB



| ①Accessories code | ②Valve type | ③Accessories type |
|-------------------------|--|-------------------|
| F: Mounting accessories | 2S030: 030 Series valve 2S050: 050 Series valve | LB: LB Type |

[Note] The wire length is 0.5m.

Fluid control valve(2/2way)

2S Series (Direct-acting and normally closed)

Flow chart

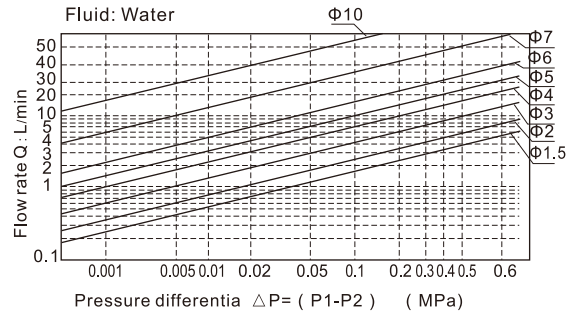
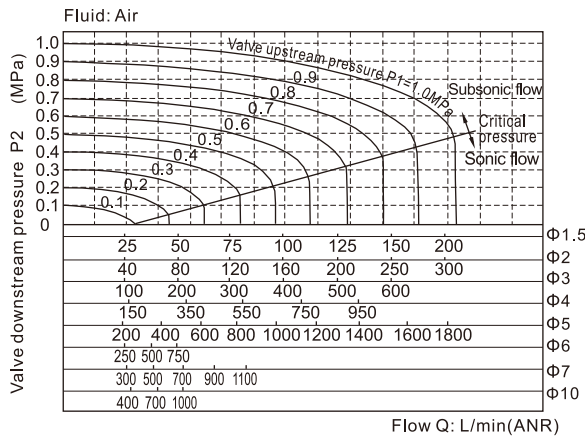

Dimensions

2S□030 (Terminal)

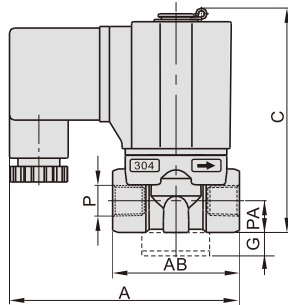
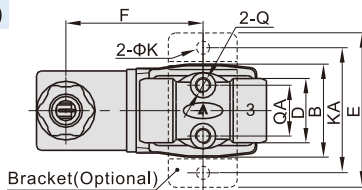

2S□030 (Grommet)

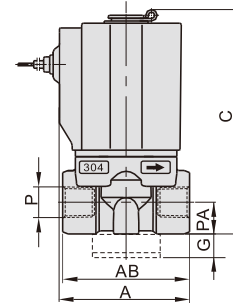
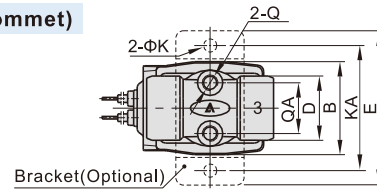

2S□050 (Terminal)

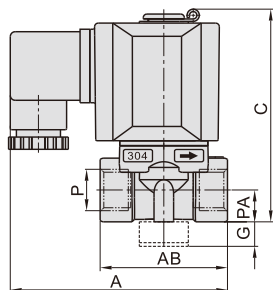
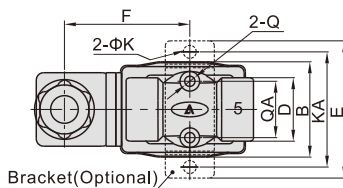

2S□050 (Grommet)

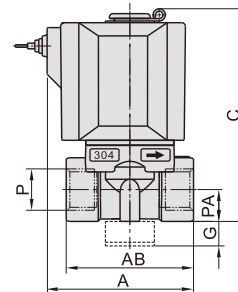
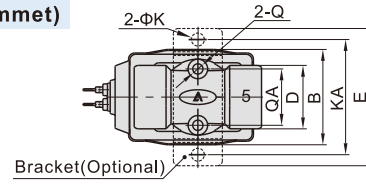

| Model\Item | A | AB | B | C | D | E | F | G | K | KA | P | PA | Q | QA |
|------------|------|----|------|----|----|----|------|----|-----|----|------|----|----|----|
| 2S□030-06 | 72.5 | 40 | 29.5 | 71 | 20 | 49 | 43.5 | 10 | 5.3 | 40 | 1/8" | 10 | M5 | 16 |
| 2S□030-08 | 72.5 | 40 | 29.5 | 71 | 20 | 49 | 43.5 | 10 | 5.3 | 40 | 1/4" | 10 | M5 | 16 |
| 2S□050-10 | 89.5 | 52 | 39 | 87 | 26 | 56 | 51 | 10 | 5.3 | 48 | 3/8" | 13 | M5 | 23 |
| 2S□050-15 | 89.5 | 52 | 39 | 87 | 26 | 56 | 51 | 10 | 5.3 | 48 | 1/2" | 13 | M5 | 23 |

| Model\Item | A | AB | B | C | D | E | G | K | KA | P | PA | Q | QA |
|------------|----|----|------|----|----|----|----|-----|----|------|----|----|----|
| 2S□030-06 | 41 | 40 | 29.5 | 71 | 20 | 49 | 10 | 5.3 | 40 | 1/8" | 10 | M5 | 16 |
| 2S□030-08 | 41 | 40 | 29.5 | 71 | 20 | 49 | 10 | 5.3 | 40 | 1/4" | 10 | M5 | 16 |
| 2S□050-10 | 60 | 52 | 39 | 87 | 26 | 56 | 10 | 5.3 | 48 | 3/8" | 13 | M5 | 23 |
| 2S□050-15 | 60 | 52 | 39 | 87 | 26 | 56 | 10 | 5.3 | 48 | 1/2" | 13 | M5 | 23 |